

| | | | |
|-----------------------------|---------------|---|--------------------|
| STATE | FEDERAL AID | STATE | SHEET NO. |
| ROUTE | PROJECT | ROUTE | PROJECT |
| VA. — | BR-5104 (159) | 20 | 0020-104-101, B601 |
| 1 | | | |
| NBIS Number: 00000000031086 | | UPC No. 75878 | |
| Federal Oversight Code: NFO | | FHWA Construction and Scour Code: X581-SN | |

DESIGN EXCEPTION(S):
None.

GENERAL NOTES:

Width: 10'-0" sidewalk, 7'-0" bike lane, 3'-0" median, 22'-0" roadway, 3'-0" median, 7'-0" bike lane, 10'-0" sidewalk. Overall width 62'-0" face-to-face of railing.

Span layout: 57'-7 1/4" - 89'-11 1/2" - 88'-3 3/8" prestressed concrete 45" deep Bul-T beam spans continuous for live load.

Capacity: HL-93 loading.

Specifications:

Construction: Virginia Department of Transportation Road and Bridge Specification, 2014.

Design: AASHTO LRFD Bridge Design Specifications, and VDOT Modifications.

These plans are incomplete unless accompanied by the Supplemental Specifications and Special Provisions included in the contract documents.

Concrete in superstructure, including parapets, terminal walls and integral backwall shall be low shrinkage Class A4 modified. All other concrete to be Class A3. Concrete for parapets, sidewalks, medians and deck slab shall be colored Omaha Tan (city mix), per City of Charlottesville Standards and Design Manual.

All reinforcing steel shall be deformed and shall conform to ASTM A615, Grade 60 except for reinforcing steel noted as CRR (corrosion resistant reinforcing) which shall conform to applicable specifications noted in the special provision. All reinforcing bar dimensions on the detailed drawings are center of bar except where otherwise noted and are subject to fabrication and construction tolerances.

Corrosion resistant reinforcing (CRR) steels shall conform to one or more of the three types (low carbon/chromium, stainless clad and solid stainless) listed in the special provision. The minimum yield strength shall be: 100 ksi for low carbon/chromium and 60 ksi for stainless clad steel and solid stainless steel. The type(s) of CRR steel(s) required on this project is/are noted on the plan sheets and in the reinforcing steel schedule.

The existing structure is designated a type B structure in accordance with Sec. 411.

PRELIMINARY PLANS
THESE PLANS NOT TO BE USED FOR CONSTRUCTION



CITY OF CHARLOTTESVILLE
NEIGHBORHOOD DEVELOPMENT
SERVICES

9TH STREET (ROUTE 20) OVER AVON STREET,
BUCKINGHAM BRANCH RAILROAD, AND WATER
STREET

CITY OF CHARLOTTESVILLE
PROJ. 0020-104-101, B601

Recommended for Approval: _____ Date _____
UCI Program Manager/Responsible Local Government

Approved: _____ Date _____
Chief Engineer

302-08

Date: _____ © 2018, Commonwealth of Virginia Sheet 1 of 6

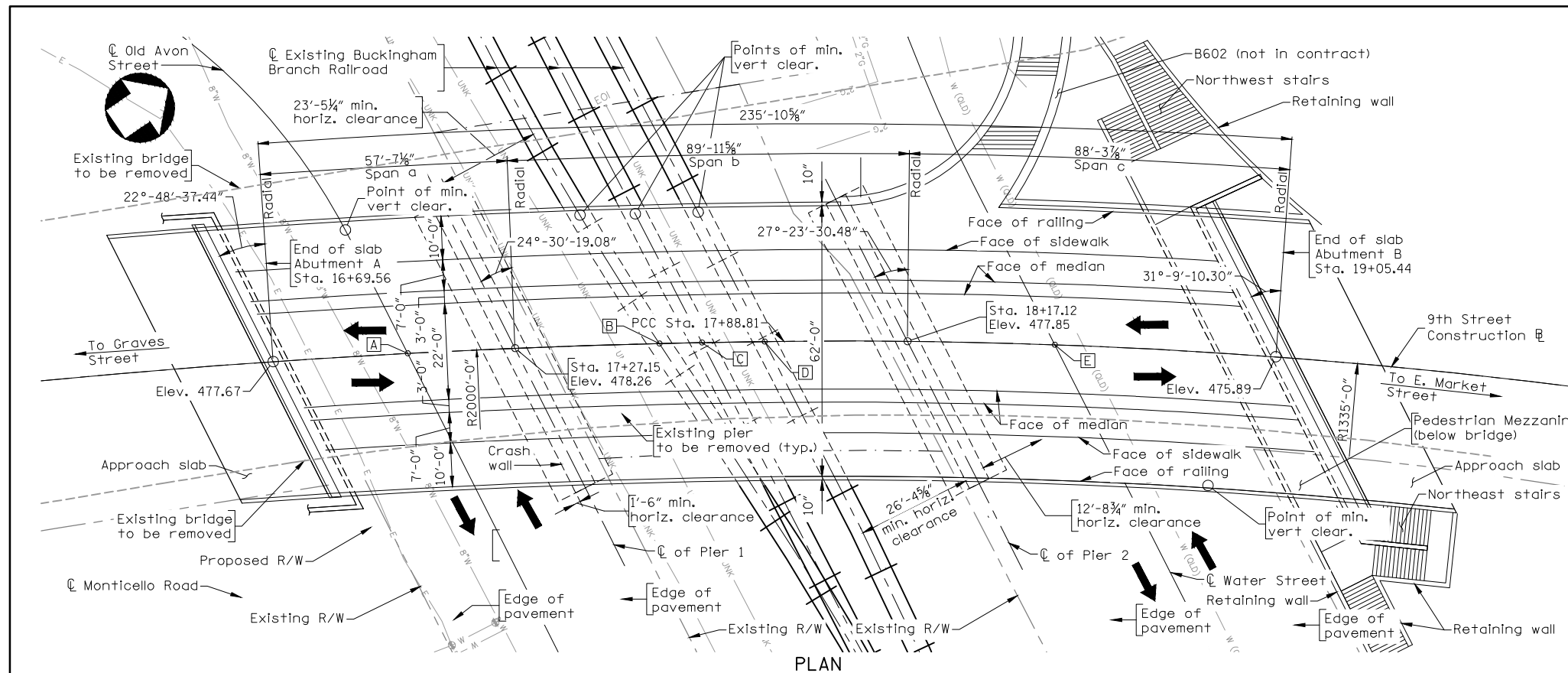

- A POC Sta. 17+02.52 9th St. constr. PI Sta. 33+77.97 Old Avon Street const.
- B C track Sta. 17+60.31 9th St. constr.
- C C track Sta. 17+70.07 9th St. constr.
- D C track Sta. 17+84.41 9th St. constr.
- E POC Sta. 18+50.89 9th St. constr. PI Sta. 62+58.69 Water Street const.

C.G. Sta. 17+20.00
C.G. Elev. 483.96
V.C. 380.00'

5.38% -4.20%

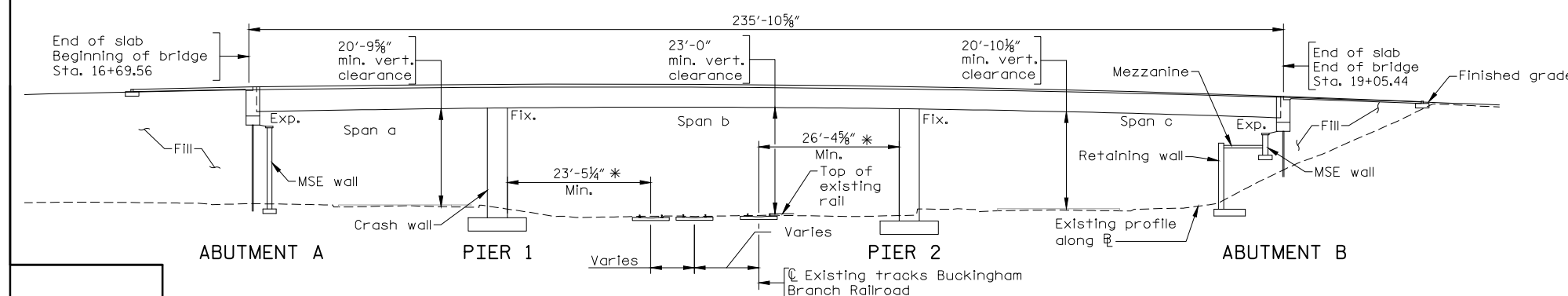

* Minimum face of pier clearance normal to track

| | |
|--|--------------------|
| KIMLEY-HORN & ASSOC. RALEIGH, NC STRUCTURAL ENGINEER | |
| PLANS BY: | Kimley-Horn |
| COORDINATED: | J. Janiczek |
| SUPERVISED: | Seth A. Denney |
| DESIGNED: | Patrick D. Cooksey |
| DRAWN: | James I. Kimble |
| CHECKED: | Seth A. Denney |

| No. | Description | Date |
|--------------------------------------|-------------|------|
| REVISIONS | | |
| For Table of Revisions, see Sheet 2. | | |

Scale: 3/4"=1'-0"

| | | | | | |
|-------|---------------|--|-------|--------------------|-------|
| STATE | FEDERAL AID | | STATE | | SHEET |
| ROUTE | PROJECT | | ROUTE | PROJECT | NO. |
| VA. | BR-5104 (159) | | 20 | 0020-104-101, B601 | 2 |

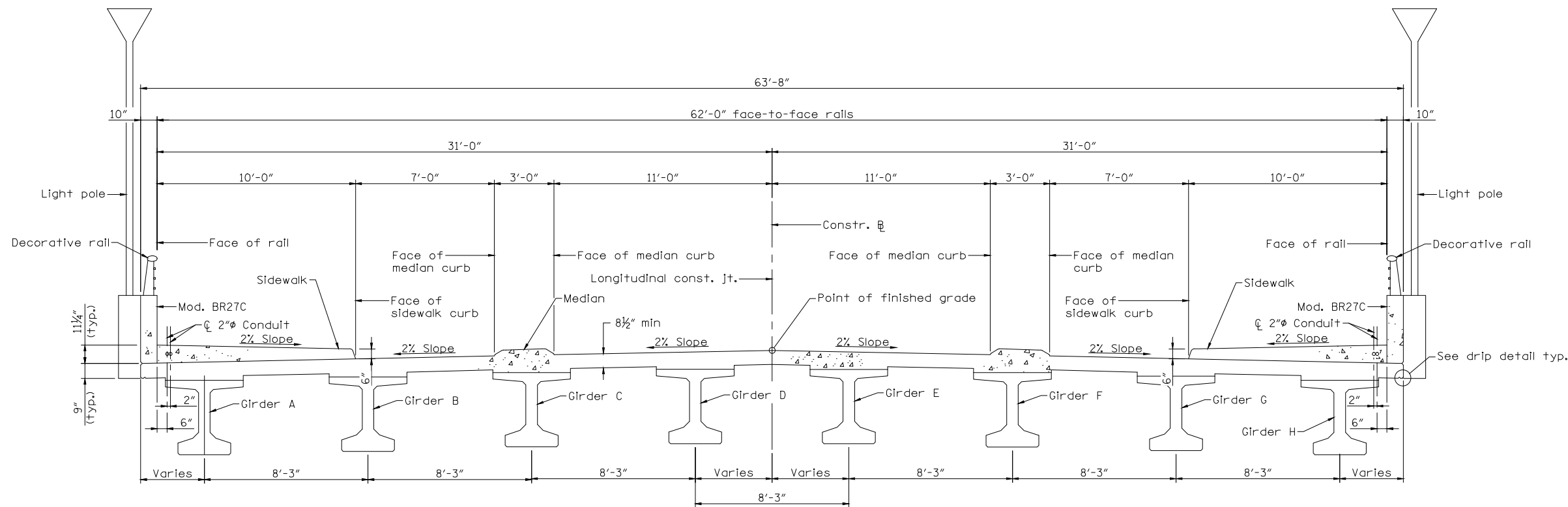

TRANSVERSE SECTION

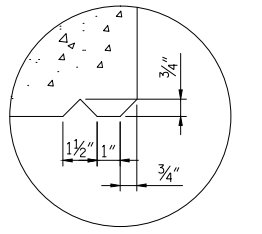

DRIP DETAIL
Not to scale

**PRELIMINARY PLANS
THESE PLANS NOT TO BE USED
FOR CONSTRUCTION**

KIMLEY-HORN & ASSOC.
RALEIGH, NC
STRUCTURAL ENGINEER

Scale: 1/4"=1'-0" © 2018, Commonwealth of Virginia

| | | | | | |
|---|-------------|------|--------------------|------------|---------------------|
| COMMONWEALTH OF VIRGINIA DEPARTMENT OF TRANSPORTATION STRUCTURE AND BRIDGE DIVISION | | | | | |
| TRANSVERSE SECTION | | | | | |
| No. | Description | Date | Designed: PDC..... | Date | Plan No. |
| | | | Drawn: JJK..... | March 2018 | |
| | | | Checked: SAA..... | | |
| Revisions | | | | | Sheet No. 2 of 6 |

| | | | | | |
|-------|-------------|---------------|-------|--------------------|-------|
| STATE | FEDERAL AID | | STATE | | SHEET |
| VA. | ROUTE | PROJECT | ROUTE | PROJECT | NO. |
| — | — | BR-5104 (159) | 20 | 0020-104-101, B601 | 3 |

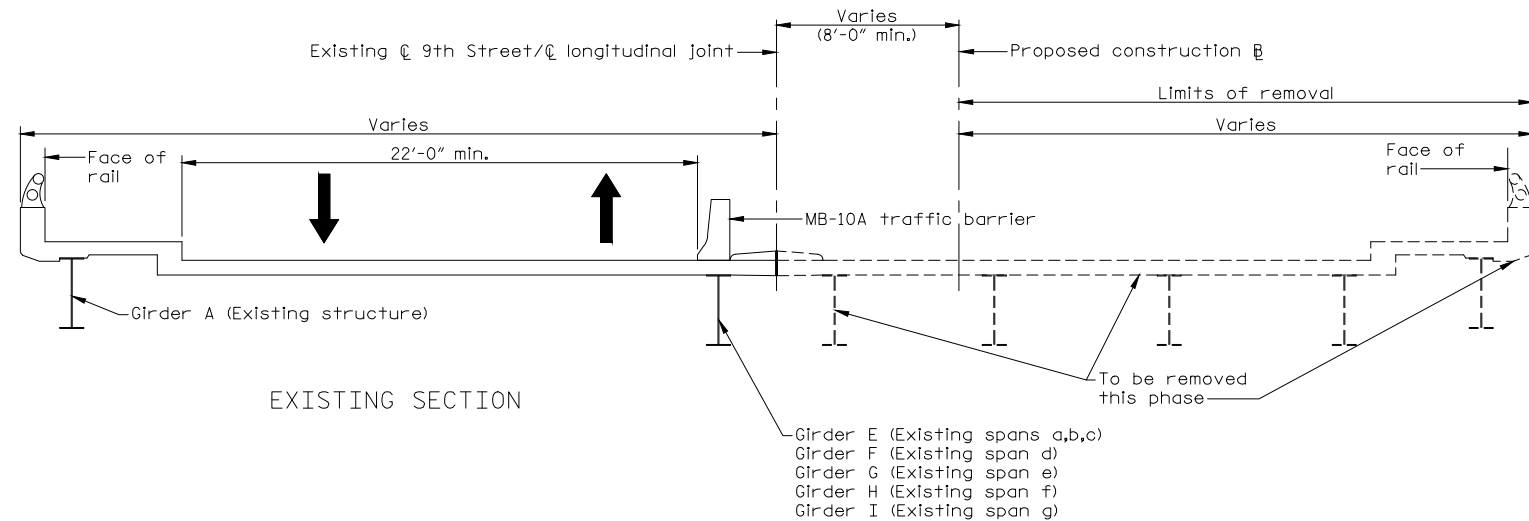

EXISTING SECTION

STAGE 1 - PHASE 1A

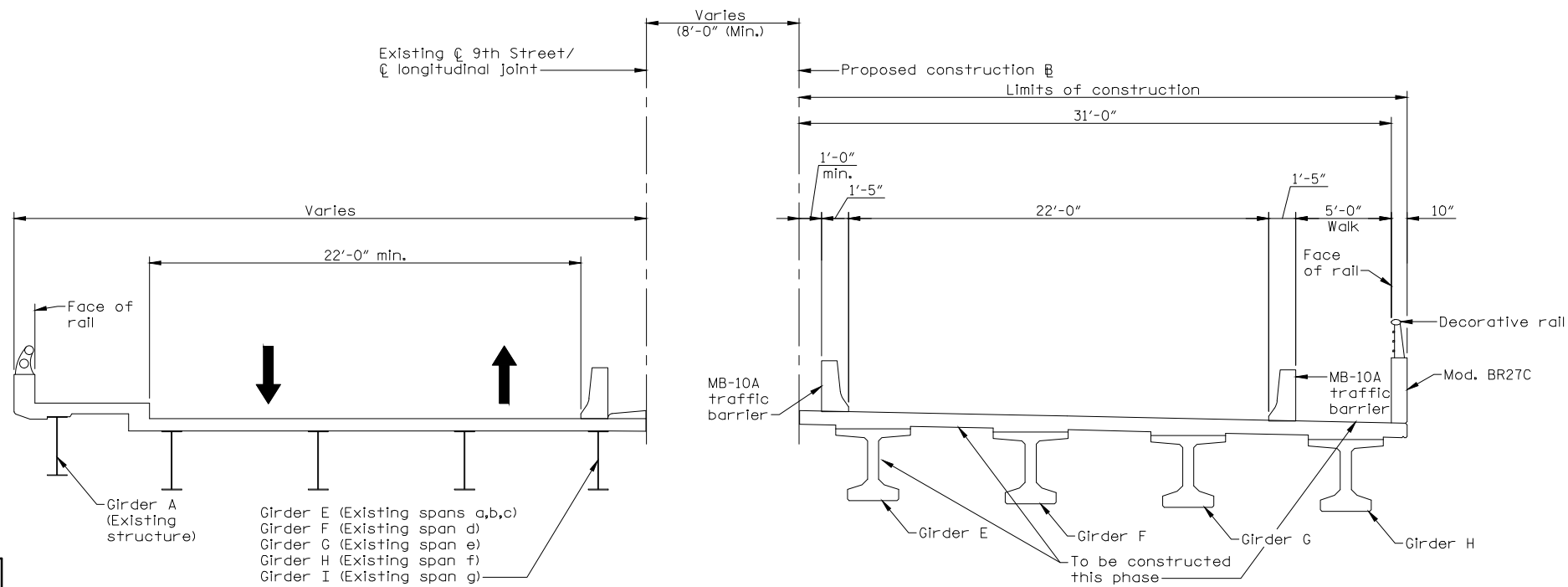

EXISTING SECTION

STAGE 1 - PHASE 2

**PRELIMINARY PLANS
THESE PLANS NOT TO BE USED
FOR CONSTRUCTION**

KIMLEY-HORN & ASSOC.
RALEIGH, NC
STRUCTURAL ENGINEER

Scale: 1/4"=1'-0"

© 2018, Commonwealth of Virginia

| | | | | | |
|---|-------------|------|--------------------|------------|----------|
| COMMONWEALTH OF VIRGINIA DEPARTMENT OF TRANSPORTATION STRUCTURE AND BRIDGE DIVISION | | | | | |
| SEQUENCE OF CONSTRUCTION I | | | | | |
| No. | Description | Date | Designed: PDC..... | Date | Plan No. |
| | | | Drawn: JJK..... | March 2018 | |
| | | | Checked: SAA..... | | |
| Revisions | | | | | 3 of 6 |

| | | | | | |
|-------|---------------|--|-------|--------------------|-------|
| STATE | FEDERAL AID | | STATE | | SHEET |
| ROUTE | PROJECT | | ROUTE | PROJECT | NO. |
| VA. | BR-5104 (159) | | 20 | 0020-104-101, B601 | 4 |

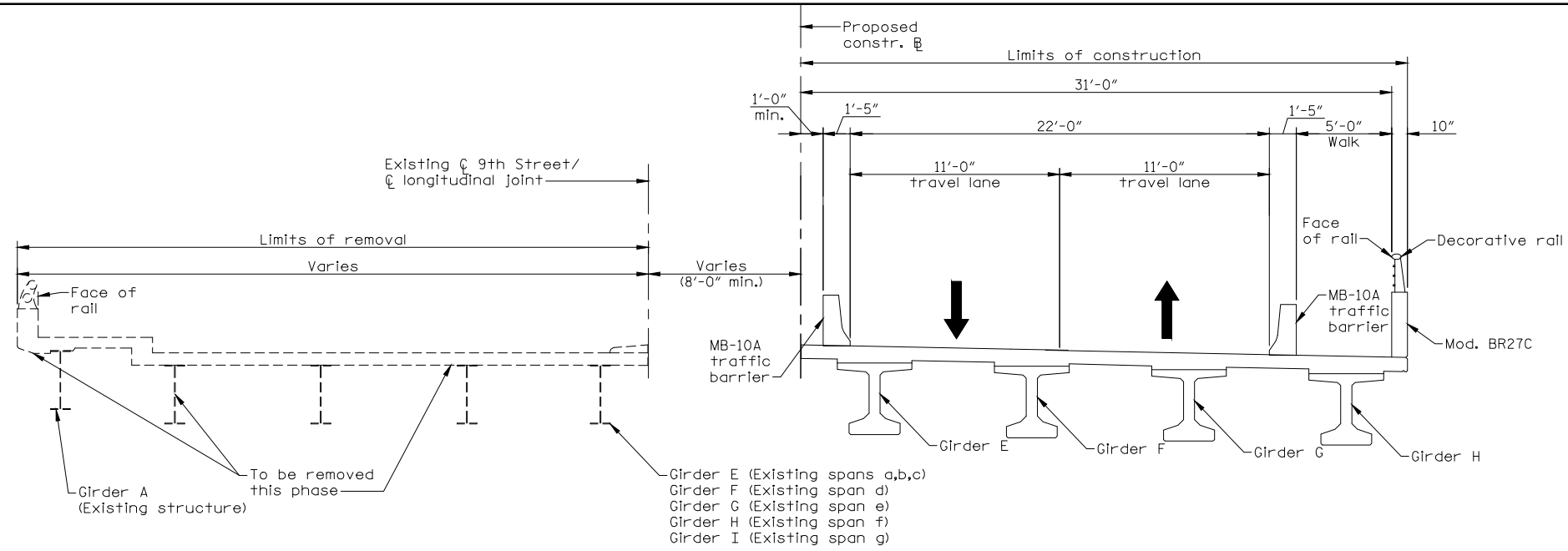

STAGE 2 - PHASE 1

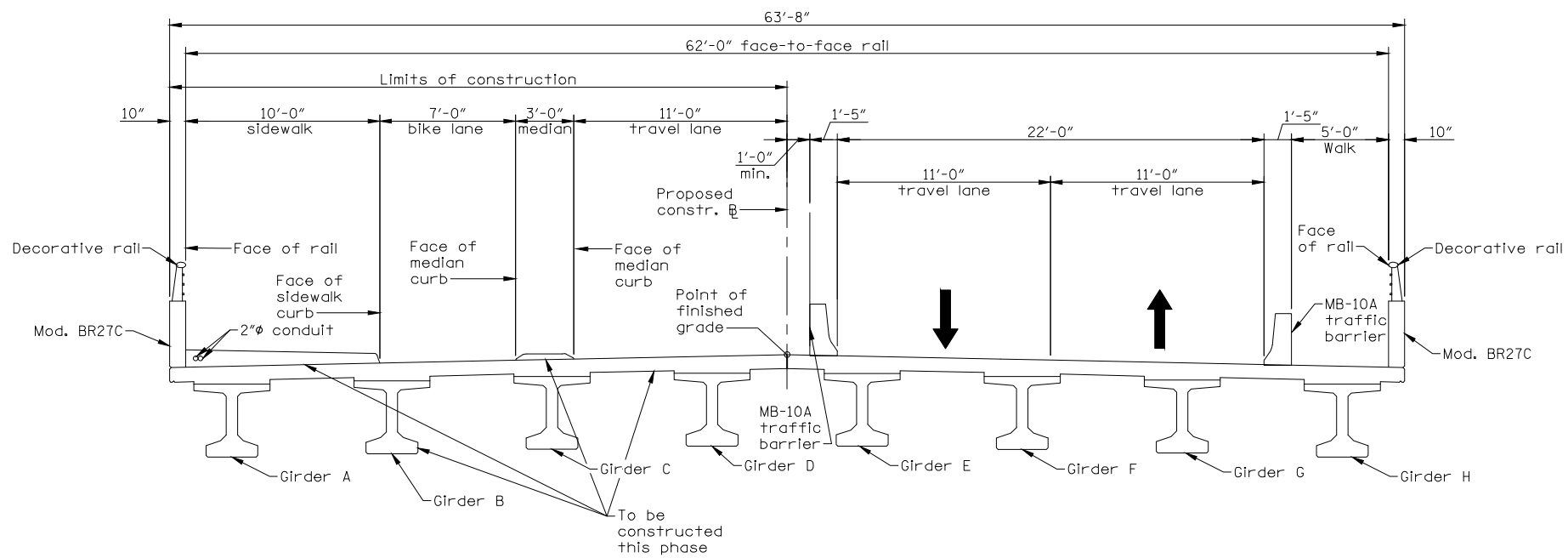

STAGE 2 - PHASE 2

**PRELIMINARY PLANS
THESE PLANS NOT TO BE USED
FOR CONSTRUCTION**

KIMLEY-HORN & ASSOC.
RALEIGH, NC
STRUCTURAL ENGINEER

Scale: 1/4"=1'-0" © 2018, Commonwealth of Virginia

| | | | | | |
|---|-------------|------|--------------------|------------|---------------------|
| COMMONWEALTH OF VIRGINIA DEPARTMENT OF TRANSPORTATION STRUCTURE AND BRIDGE DIVISION | | | | | |
| SEQUENCE OF CONSTRUCTION II | | | | | |
| No. | Description | Date | Designed: PDC..... | Date | Plan No. |
| | | | Drawn: JJK..... | March 2018 | |
| | | | Checked: SAA..... | | |
| Revisions | | | | | Sheet No. 4 of 6 |

| | | | | | |
|-------|---------------|--|-------|--------------------|-------|
| STATE | FEDERAL AID | | STATE | | SHEET |
| ROUTE | PROJECT | | ROUTE | PROJECT | NO. |
| VA. | BR-5104 (159) | | 20 | 0020-104-101, B601 | 5 |

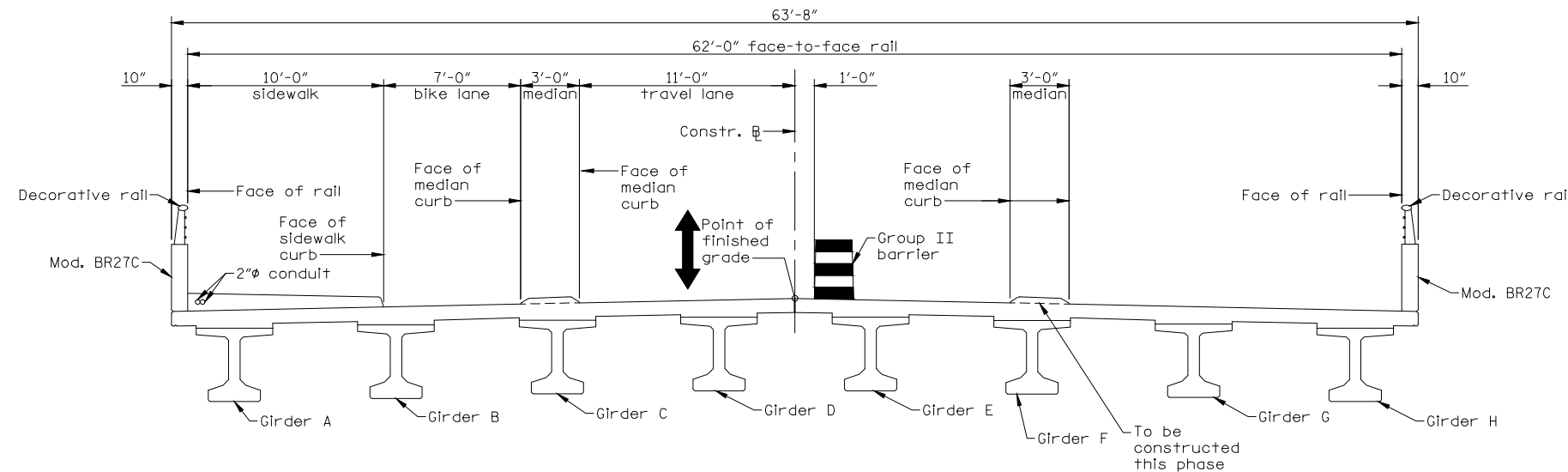

STAGE 3

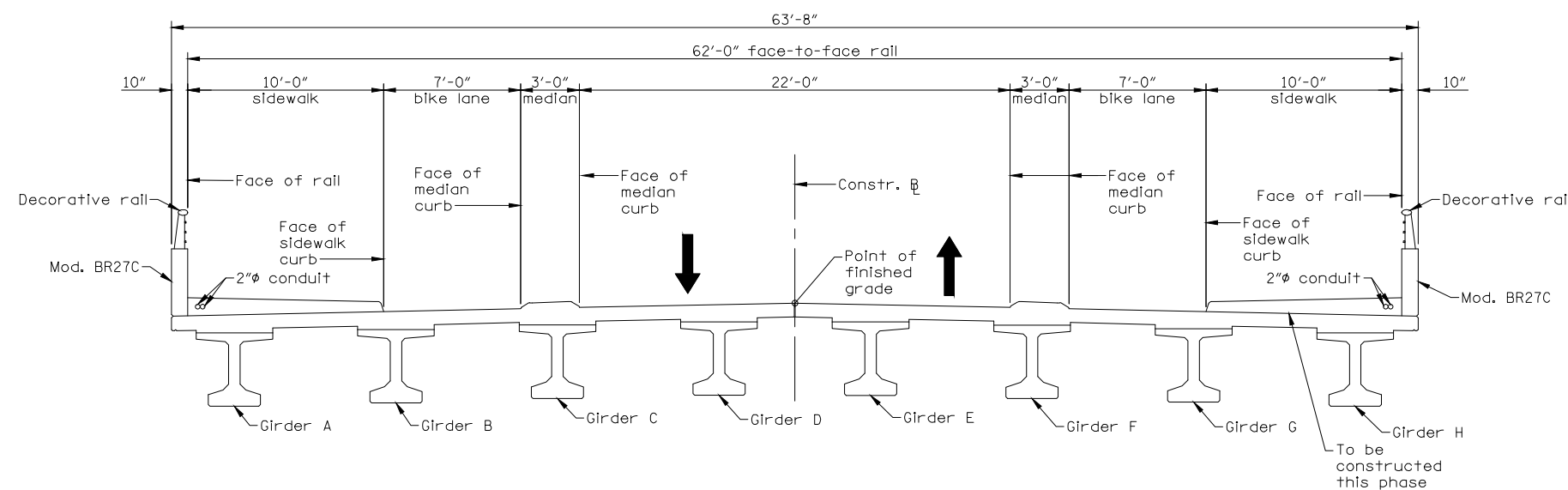

STAGE 4

**PRELIMINARY PLANS
THESE PLANS NOT TO BE USED
FOR CONSTRUCTION**

KIMLEY-HORN & ASSOC.
RALEIGH, NC
STRUCTURAL ENGINEER

Scale: 1/4"=1'-0" © 2018, Commonwealth of Virginia

| | | | | | |
|--|-------------|------|--------------------|------------|---------------------|
| COMMONWEALTH OF VIRGINIA DEPARTMENT OF TRANSPORTATION | | | | | |
| STRUCTURE AND BRIDGE DIVISION | | | | | |
| SEQUENCE OF CONSTRUCTION III | | | | | |
| No. | Description | Date | Designed: PDC..... | Date | Plan No. |
| | | | Drawn: JJK..... | March 2018 | |
| | | | Checked: SJD..... | | |
| Revisions | | | | | Sheet No. 5 of 6 |

| | | | | | |
|-------|-------------|---------------|-------|--------------------|-------|
| STATE | FEDERAL AID | | STATE | | SHEET |
| VA. | ROUTE | PROJECT | ROUTE | PROJECT | NO. |
| — | | BR-5104 (159) | 20 | 0020-104-101, B601 | 6 |

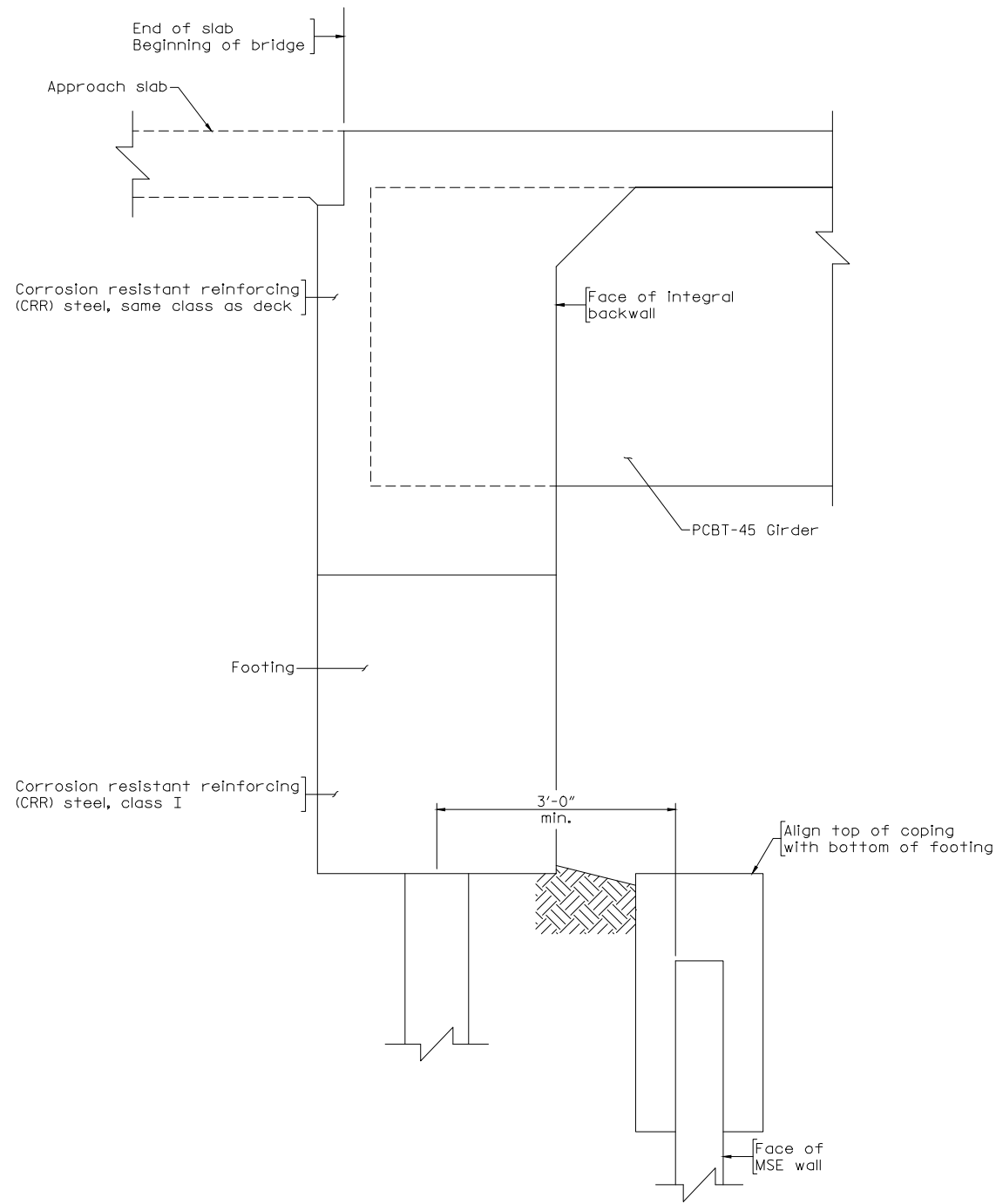

ABUTMENT SIDE VIEW

PRELIMINARY PLANS
THESE PLANS NOT TO BE USED FOR CONSTRUCTION

KIMLEY-HORN & ASSOC.
RALEIGH, NC
STRUCTURAL ENGINEER

Scale: 1"=1'-0 unless otherwise noted

© 2018, Commonwealth of Virginia

| | | | | | | |
|--|-------------|------|--|--------------------|----------|---------------------|
| COMMONWEALTH OF VIRGINIA DEPARTMENT OF TRANSPORTATION | | | | | | |
| STRUCTURE AND BRIDGE DIVISION | | | | | | |
| ABUTMENT DETAIL | | | | | | |
| No. | Description | Date | Designed: PDC..... Drawn: JJK..... Checked: SAA..... | Date March 2018 | Plan No. | Sheet No. 6 of 6 |
| Revisions | | | | | | |